

Ventspils Ganību iela

Installation : Avārijas apgaismojums

Project number : 1

Customer :

Processed by : Artūrs Karulis

Date : 06.02.2018

The following values are based on exact calculations on calibrated lamps, luminaires and their arrangement. In practice, gradual divergences can occur.

Guarantee claims for luminaire data are excluded.

Relux and the luminaire manufacturers accept no liability for consequential damage and damage which is occasioned to the user or to third parties.

Object : Ventspils Ganību iela
 Installation : Avārijas apgaismojums
 Project number : 1
 Date : 06.02.2018

RELUX®

1 116

1.1 Description, 116

1.1.1 Floor plan

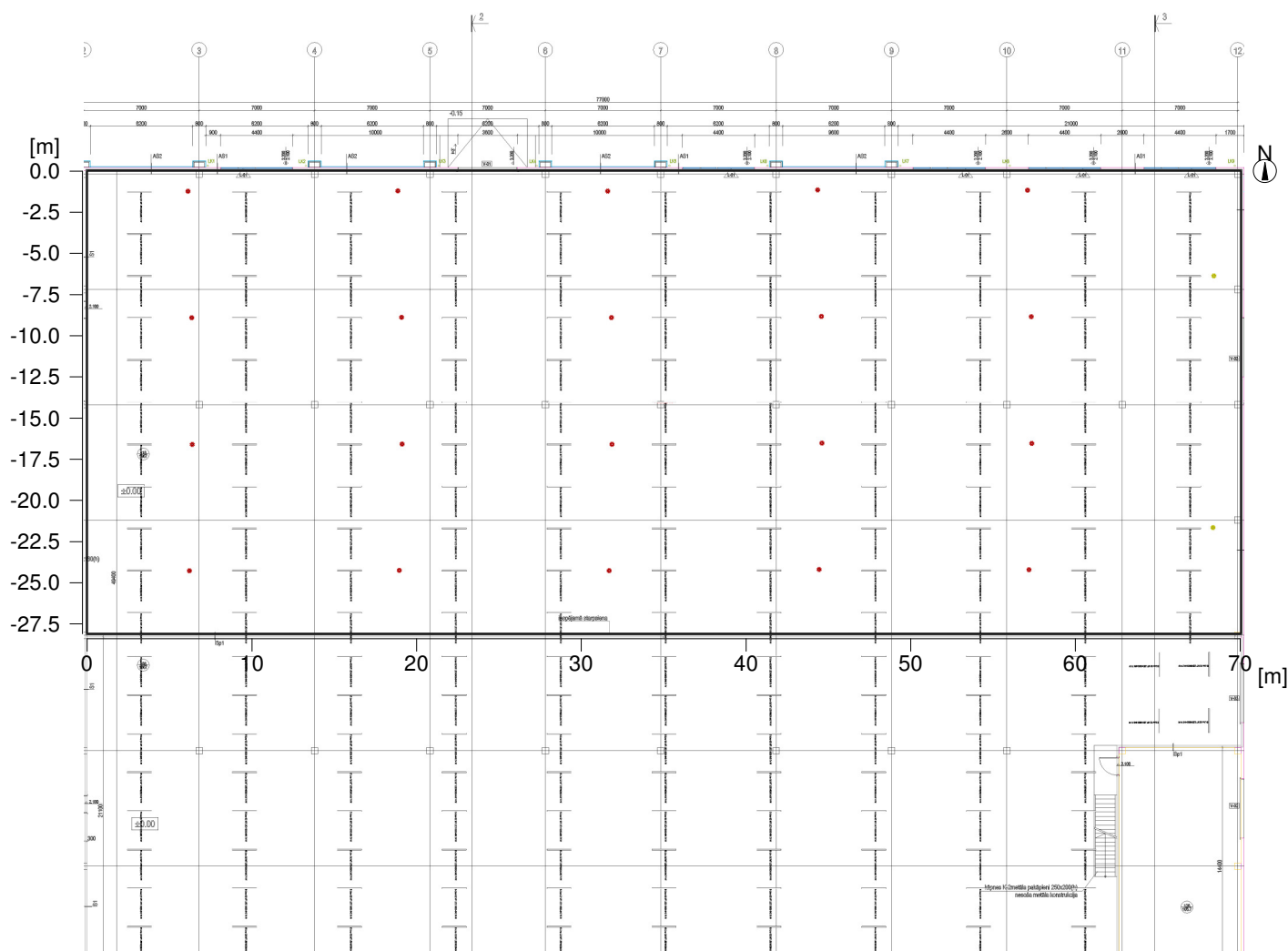

Wall	x	y	Length	Reflectance
1	75.30 m	217.93 m	28.10 m	50.0 %
2	145.30 m	217.94 m	70.00 m	50.0 %
3	145.30 m	246.03 m	28.10 m	50.0 %
4	75.30 m	246.03 m	70.00 m	50.0 %
Floor				20.0 %
Ceiling				70.0 %
Room height		7.00 m		
Height of reference plane		0.00 m		

-please put your own address here-

1 116

1.2 Summary, 116

1.2.1 Result overview, Evaluation area 1

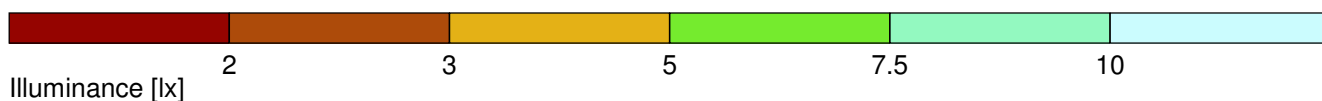
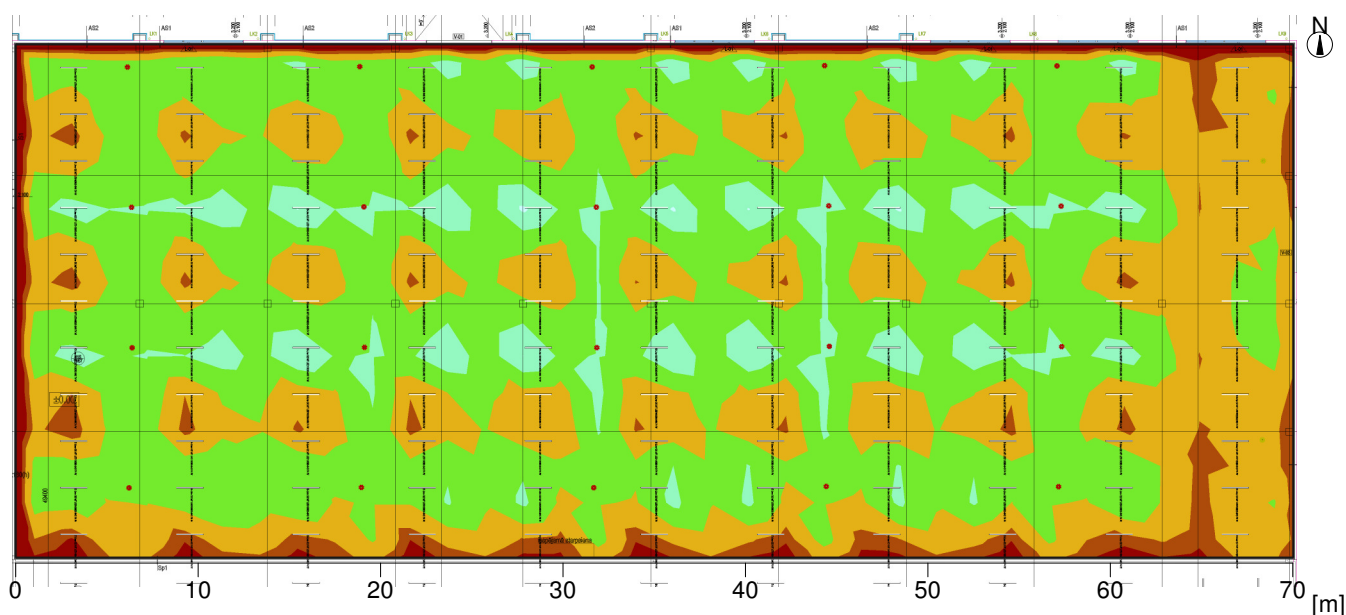

General

Calculation algorithm used
 Height of luminaire plane
 Maintenance factor

Average indirect fraction
 7.00 m
 0.80

Total luminous flux of all lamps
 Total power
 Total power per area (1966.93 m²)

13600.00 lm
 137.2 W
 0.07 W/m² (1.34 W/m²/100lx)

Evaluation area 1

Reference plane 1.1

Horizontal
 Em
 Emin
 Emin/Eav (Uo)
 Emin/Emax (Ud)
 Position

5.21 lx
 1.77 lx
 0.34
 0.18
 0.00 m

Type No.\Make

- | | | | |
|---|----|----------------|---|
| 1 | 2 | AWEX | |
| | | Order No. | : AXN |
| | | Luminaire name | : AXNC_6W_B_SE |
| | | Equipment | : 1 x AXNC/6W/B... (SE-MODE) 8.6 W / 600 lm |
| 5 | 20 | | |
| | | Order No. | : AXNU/6W/B/SE |
| | | Luminaire name | : AXNU/6W/B/SE |
| | | Equipment | : 1 x AXNU/6W/B/SE 6 W / 620 lm |

2 106

2.1 Description, 106

2.1.1 Floor plan

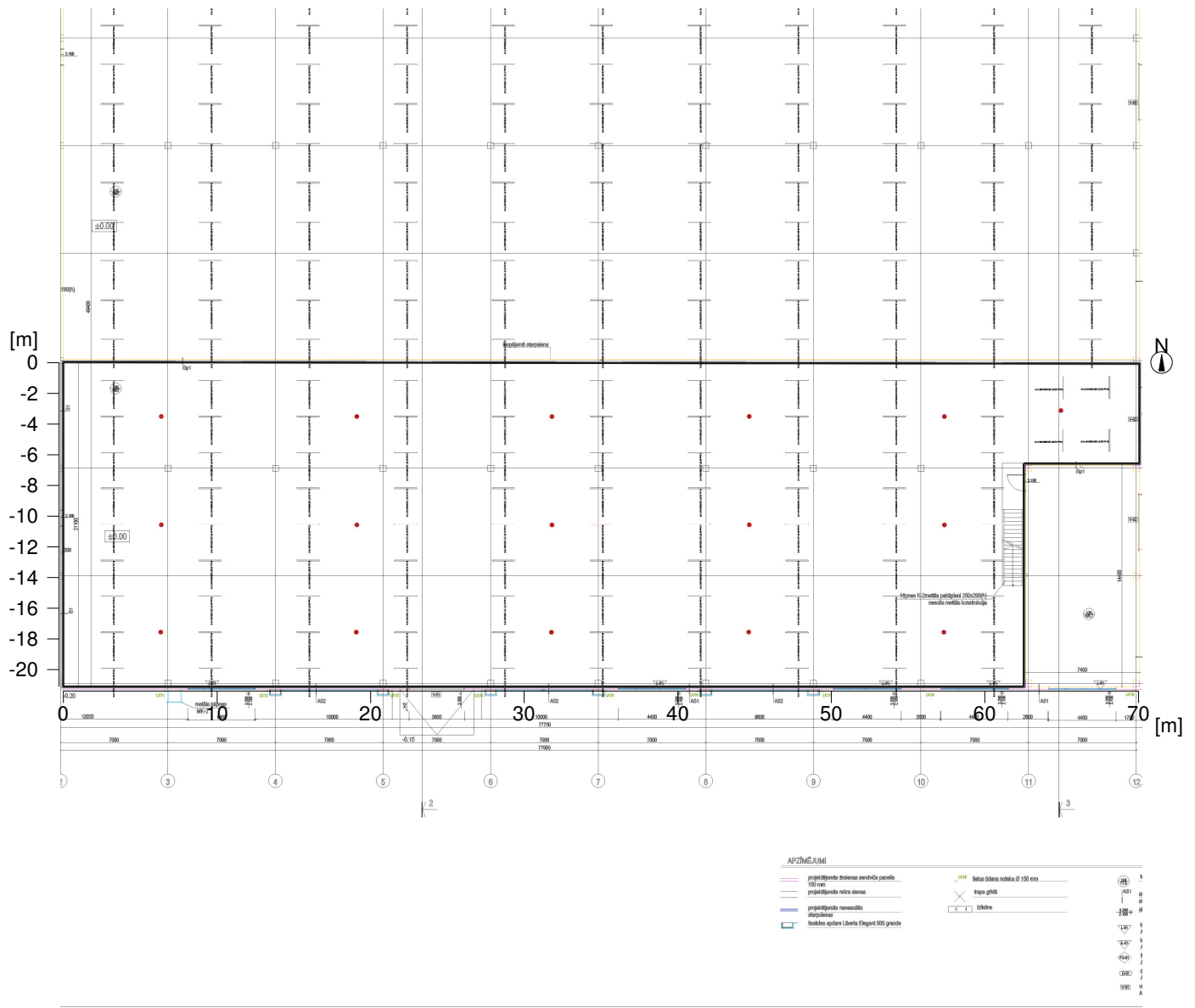

Wall	x	y	Length	Reflectance
1	75.30 m	196.63 m	21.10 m	50.0 %
2	137.78 m	196.63 m	62.48 m	50.0 %
3	137.78 m	211.15 m	14.52 m	50.0 %
4	145.30 m	211.15 m	7.52 m	50.0 %
5	145.30 m	217.63 m	6.48 m	50.0 %
6	75.30 m	217.73 m	70.00 m	50.0 %
Floor				20.0 %
Ceiling				70.0 %
Room height		7.00 m		
Height of reference plane		0.00 m		

Object : Ventspils Ganību iela
 Installation : Avārijas apgaismojums
 Project number : 1
 Date : 06.02.2018

RELUX®

2 106

2.2 Summary, 106

2.2.1 Result overview, Evaluation area 1

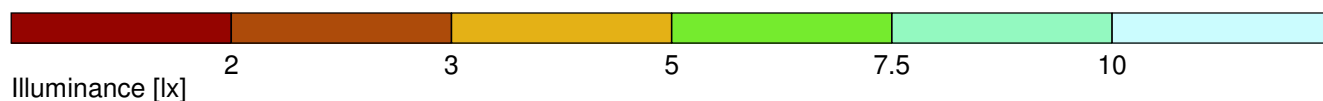
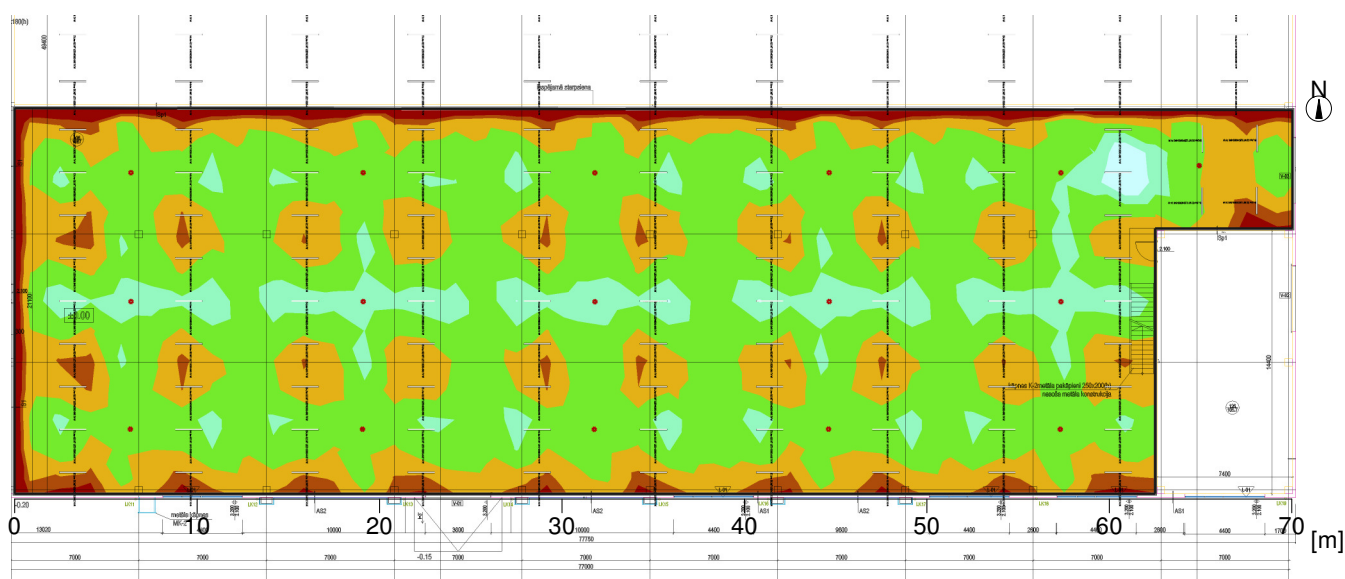

General

Calculation algorithm used
 Height of luminaire plane
 Maintenance factor

Average indirect fraction
 7.00 m
 0.80

Total luminous flux of all lamps
 Total power
 Total power per area (1364.31 m²)

9920.00 lm
 96.0 W
 0.07 W/m² (1.32 W/m²/100lx)

Evaluation area 1

Reference plane 1.1

Horizontal
 E_m 5.33 lx
 E_{min} 1.89 lx
 E_{min}/E_{av} (U_o) 0.36
 E_{min}/E_{max} (U_d) 0.15
 UGR (12.1H 3.7H) ≤37.5
 Position 0.00 m

Type No.\Make

5 16 **AWEX**
 Order No. : AXNU/6W/B/SE
 Luminaire name : AXNU/6W/B/SE
 Equipment : 1 x AXNU/6W/B/SE 6 W / 620 lm

RELUX®

3 115

3.2 Summary, 115

3.2.1 Result overview, Evaluation area 1

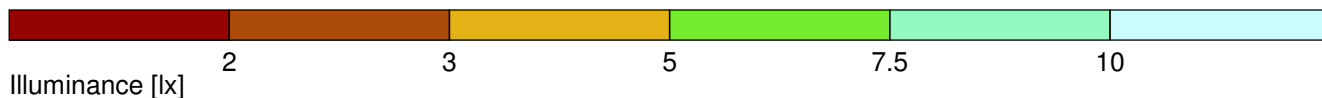
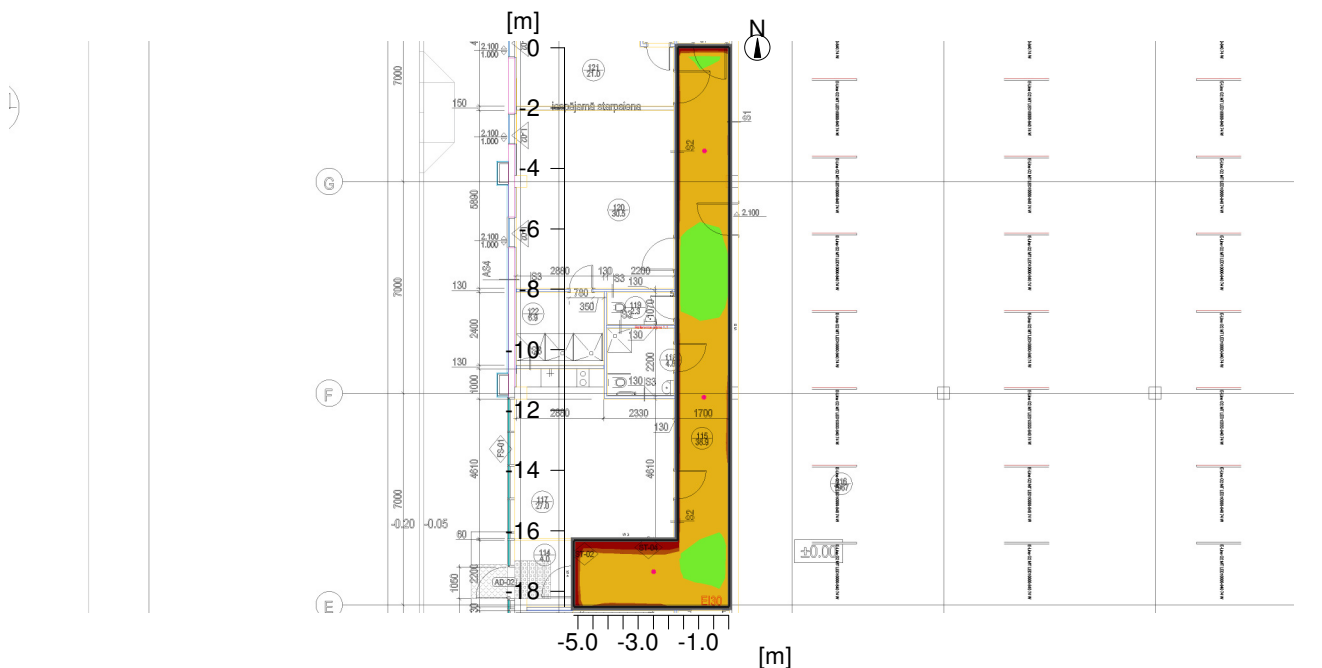

General

Calculation algorithm used
 Height of luminaire plane
 Maintenance factor

Average indirect fraction
 2.50 m
 0.80

Total luminous flux of all lamps
 Total power
 Total power per area (39.04 m²)

480.00 lm
 3.0 W
 0.08 W/m² (1.86 W/m²/100lx)

Evaluation area 1

Reference plane 1.1

Horizontal
 Em
 Emin
 Emin/Eav (Uo)
 Emin/Emax (Ud)
 Position

4.12 lx
 3.05 lx
 0.74
 0.54
 0.00 m

Type No. Make

4 3 **AWEX**
 Order No. : AXPR/1W - CB
 Luminaire name : AXPR/1W - CB
 Equipment : 1 x AXPR/1W - CB 1 W / 160 lm

4 103

4.1 Description, 103

4.1.1 Floor plan

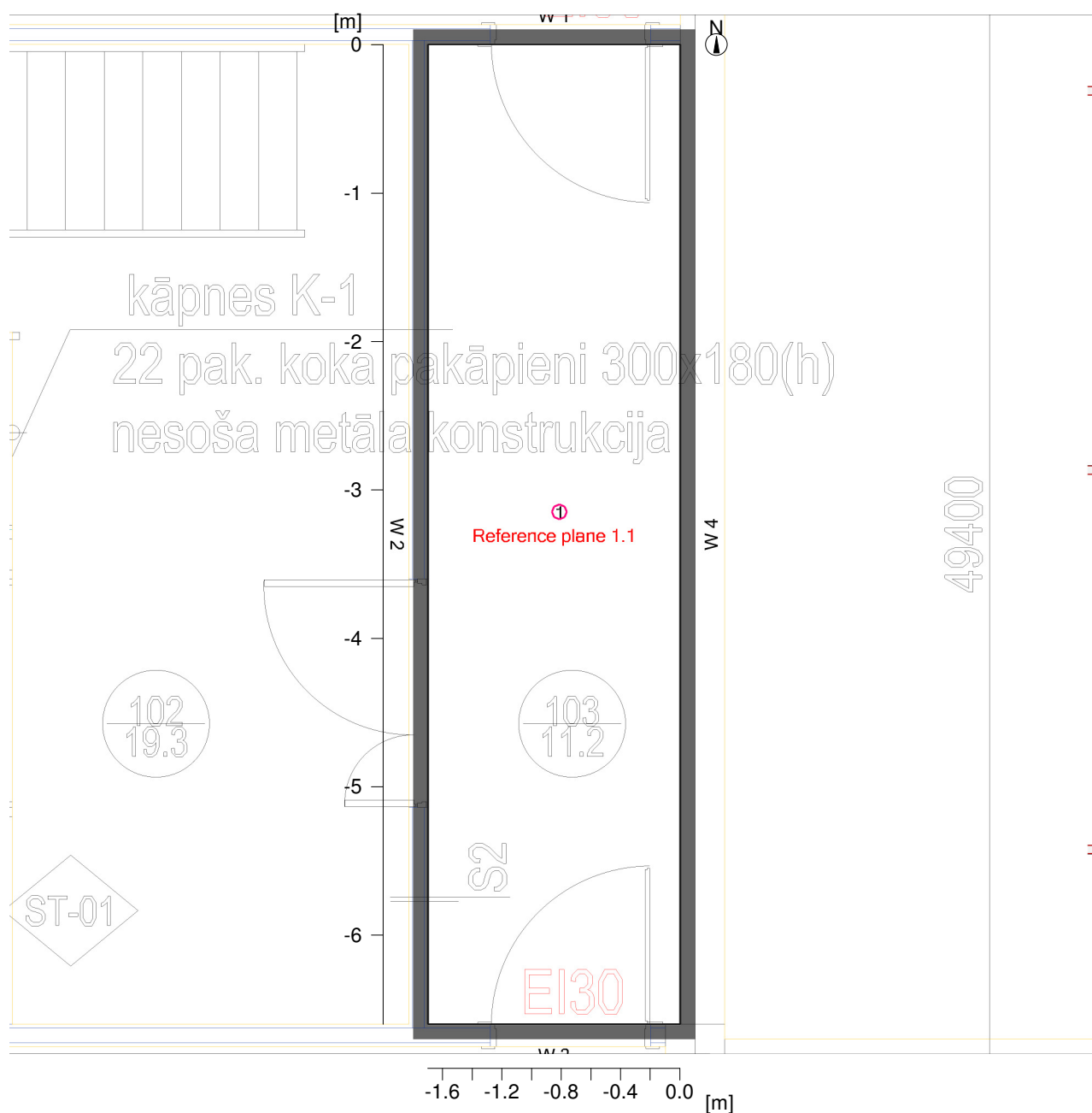

Wall	x	y	Length	Reflectance
1	73.30 m	224.63 m	1.70 m	50.0 %
2	73.30 m	218.03 m	6.60 m	50.0 %
3	75.00 m	218.03 m	1.70 m	50.0 %
4	75.00 m	224.63 m	6.60 m	50.0 %
Floor				20.0 %
Ceiling				70.0 %
Room height		3.00 m		
Height of reference plane		0.00 m		

Object : Ventspils Ganību iela
Installation : Avārijas apgaismojums
Project number : 1
Date : 06.02.2018

RELUX®

4 103

4.2 Summary, 103

4.2.1 Result overview, Evaluation area 1

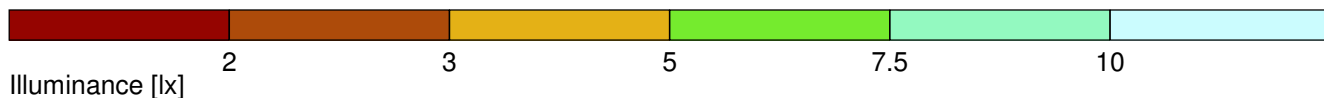
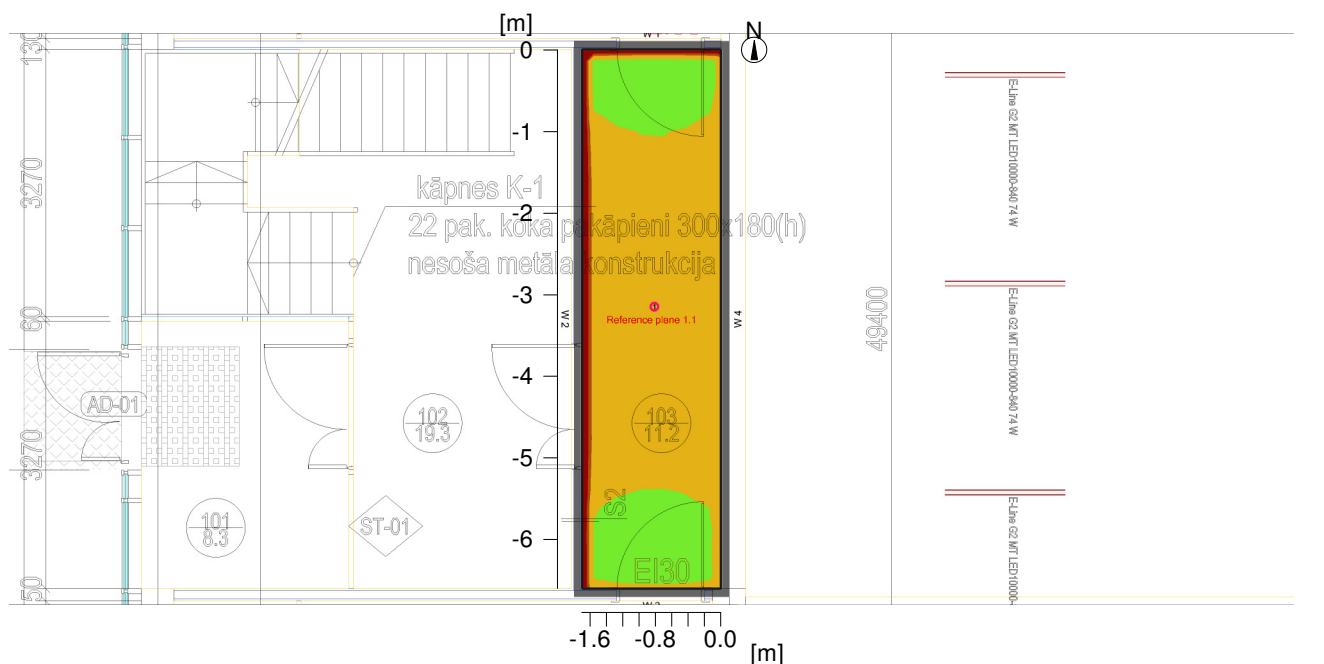

General

Calculation algorithm used
Height of luminaire plane
Maintenance factor

Average indirect fraction
2.30 m
0.80

Total luminous flux of all lamps
Total power
Total power per area (11.22 m²)

160.00 lm
1.0 W
0.09 W/m² (2.03 W/m²/100lx)

Evaluation area 1

Reference plane 1.1

Horizontal
E_m
E_{min}
E_{min}/E_{av} (U_o)
E_{min}/E_{max} (U_d)
UGR (1.6H 6.1H)
Position

4.4 lx
3.41 lx
0.78
0.58
≤42.7
0.00 m

Type No.\Make

4 1 **AWEX**
Order No. : AXPR/1W - CB
Luminaire name : AXPR/1W - CB
Equipment : 1 x AXPR/1W - CB 1 W / 160 lm

RELUX®

Object : Ventspils Ganību iela
Installation : Avārijas apgaismojums
Project number : 1
Date : 06.02.2018

RELUX®

5 102

5.2 Summary, 102

5.2.1 Result overview, Evaluation area 1

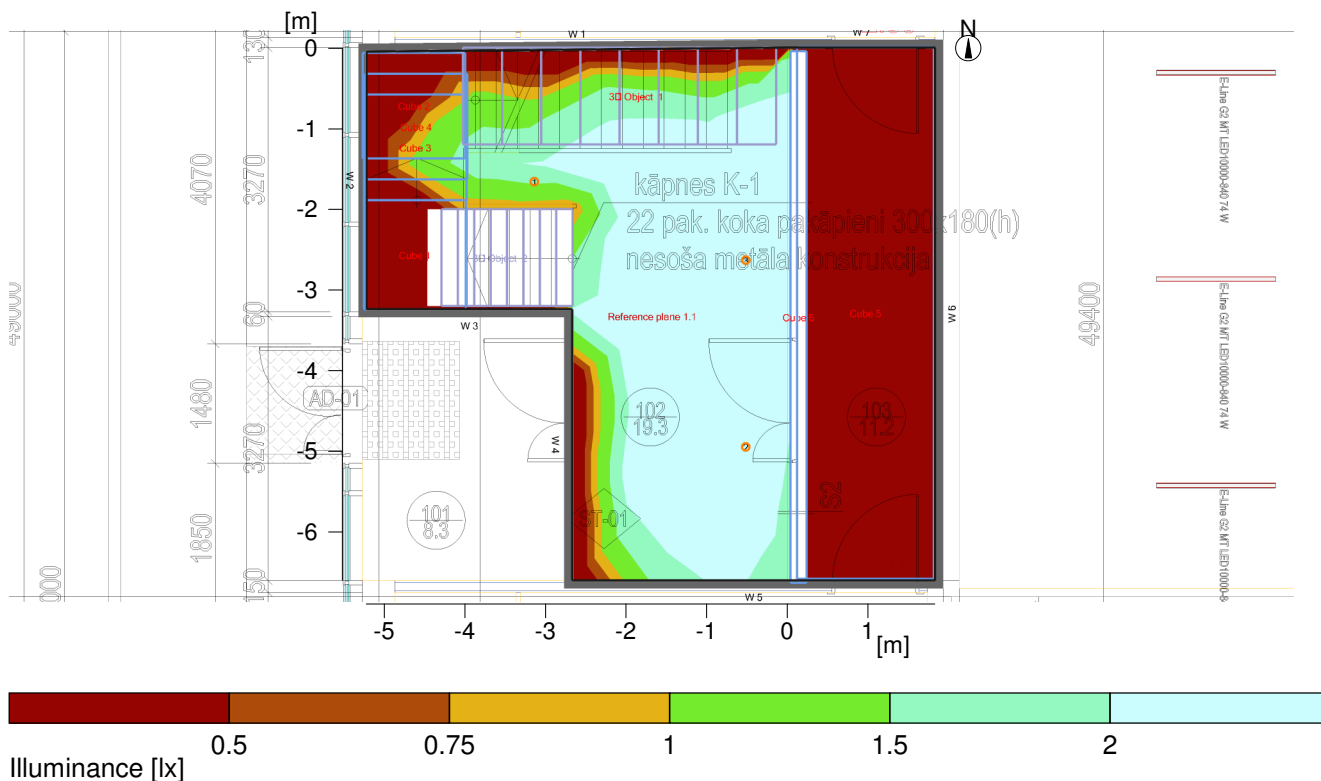

General

Calculation algorithm used
Height of luminaire plane
Maintenance factor

Average indirect fraction
7.00 m
0.80

Total luminous flux of all lamps
Total power
Total power per area (37.83 m²)

450.00 lm
3.0 W
0.08 W/m² (6.82 W/m²/100lx)

Evaluation area 1

Reference plane 1.1

Horizontal
E_m
E_{min}
E_{min}/E_{av} (U_o)
E_{min}/E_{max} (U_d)
UGR (2.0H 2.0H)
Position

1.16 lx
0 lx

≤31.8
0.00 m

Type No.\Make

3 3 **AWEX**
Order No. : AXPU/1W - CB
Luminaire name : AXPU/1W - CB
Equipment : 1 x AXPU/1W - CB 1 W / 150 lm

RELUX®

Object : Ventspils Ganību iela
Installation : Avārijas apgaismojums
Project number : 1
Date : 06.02.2018

RELUX®

6 105

6.2 Summary, 105

6.2.1 Result overview, Evaluation area 1

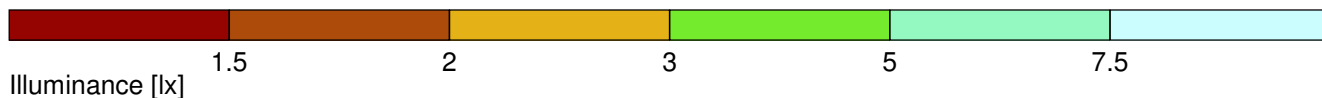
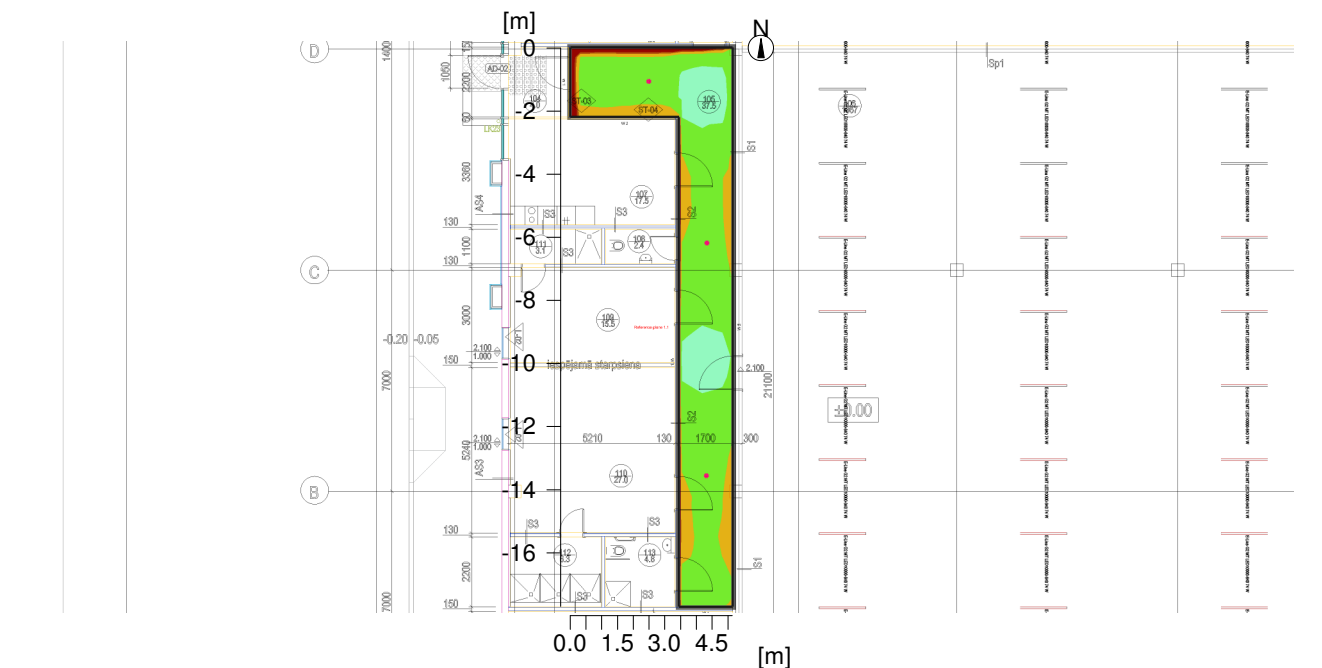

General

Calculation algorithm used
Height of luminaire plane
Maintenance factor

Average indirect fraction
3.00 m
0.80

Total luminous flux of all lamps
Total power
Total power per area (37.65 m²)

480.00 lm
3.0 W
0.08 W/m² (2.18 W/m²/100lx)

Evaluation area 1

Reference plane 1.1

Horizontal
Em
Emin
Emin/Eav (Uo)
Emin/Emax (Ud)
Position

3.66 lx
2.56 lx
0.70
0.46
0.00 m

Type No.\Make

4 3 **AWEX**
Order No. : AXPR/1W - CB
Luminaire name : AXPR/1W - CB
Equipment : 1 x AXPR/1W - CB 1 W / 160 lm

7 104

7.1 Description, 104

7.1.1 Floor plan

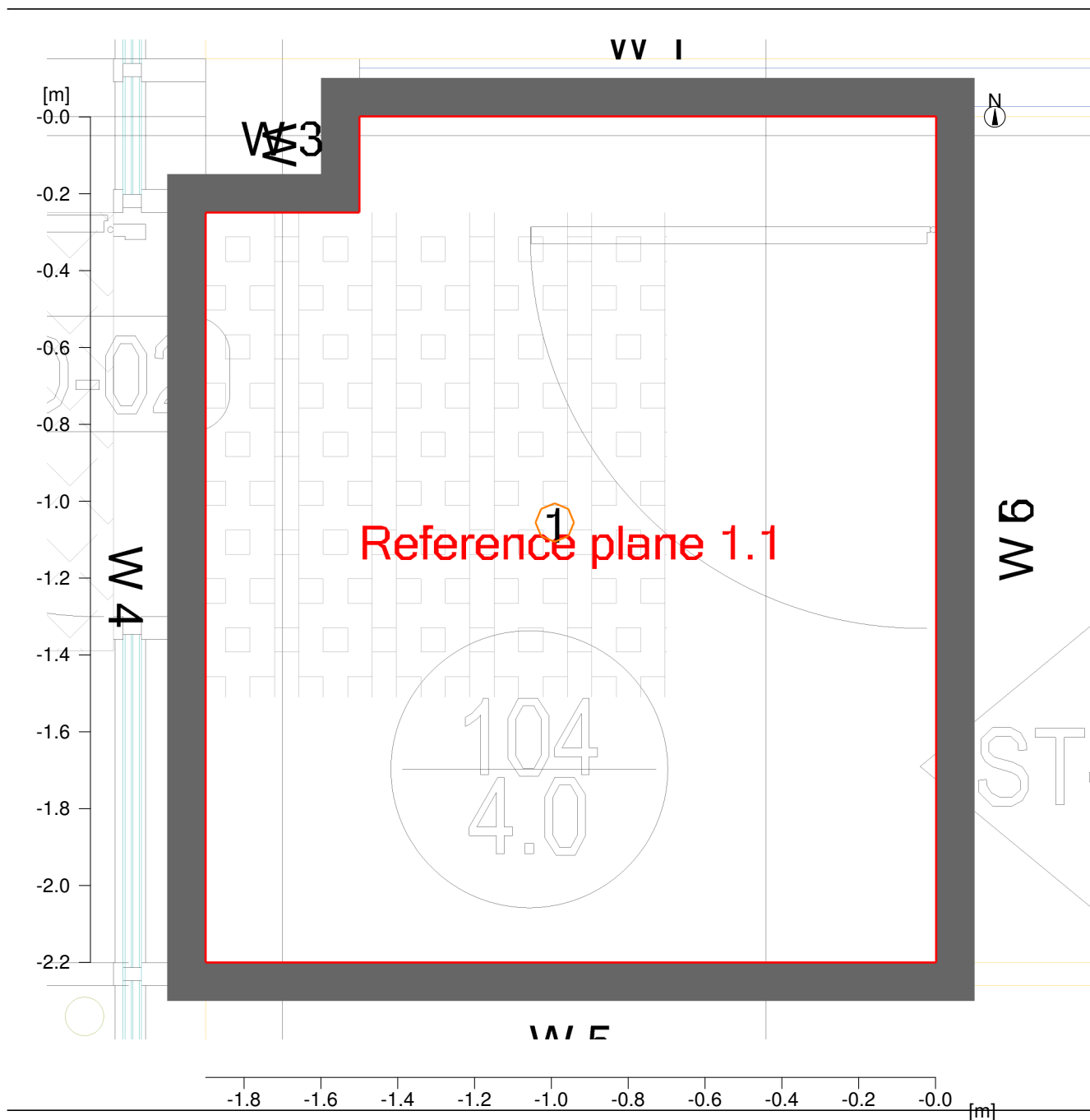

Wall	x	y	Length	Reflectance
1	68.30 m	217.88 m	1.50 m	50.0 %
2	68.30 m	217.63 m	0.25 m	50.0 %
3	67.90 m	217.63 m	0.40 m	50.0 %
4	67.90 m	215.68 m	1.95 m	50.0 %
5	69.80 m	215.68 m	1.90 m	50.0 %
6	69.80 m	217.88 m	2.20 m	50.0 %
Floor				20.0 %
Ceiling				70.0 %
Room height		3.00 m		
Height of reference plane		0.75 m		

7 104

7.2 Summary, 104

7.2.1 Result overview, Evaluation area 1

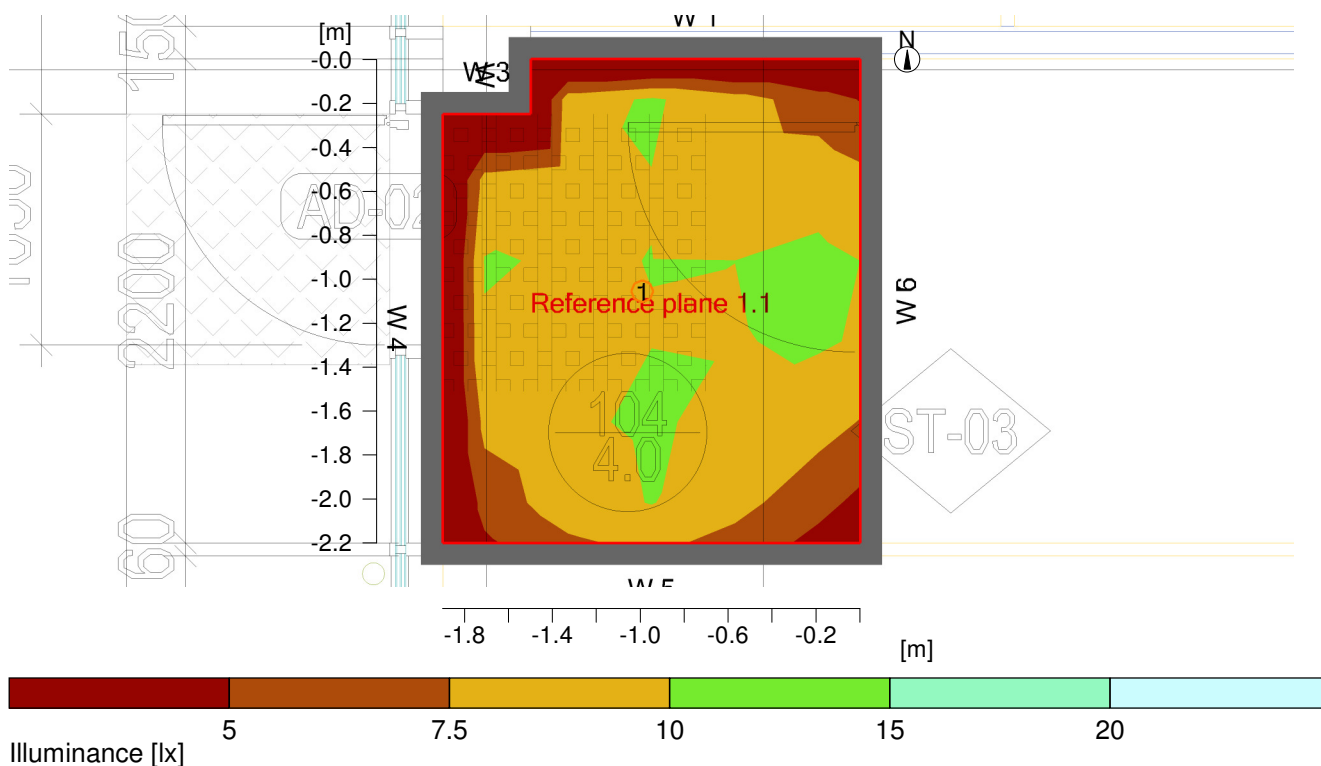

General

Calculation algorithm used
 Height of luminaire plane
 Maintenance factor

Average indirect fraction
 3.00 m
 0.80

Total luminous flux of all lamps
 Total power
 Total power per area (4.08 m²)

150.00 lm
 1.0 W
 0.25 W/m² (2.81 W/m²/100lx)

Evaluation area 1

Reference plane 1.1

Horizontal
 Em
 Emin
 Emin/Eav (Uo)
 Emin/Emax (Ud)
 UGR (2.0H 2.0H)
 Position

8.71 lx
 5.53 lx
 0.64
 0.55
 <=31.8
 0.75 m

Major surfaces

M 1.7 (Ceiling)
 M 1.1 (Wall)
 M 1.2 (Wall)
 M 1.3 (Wall)
 M 1.4 (Wall)
 M 1.5 (Wall)
 M 1.6 (Wall)

Em
 3.38 lx
 8.21 lx
 6 lx
 5.97 lx
 7.7 lx
 7.47 lx
 7.17 lx

Uo
 0.67
 0.29
 0.32
 0.33
 0.33
 0.37
 0.37

Object : Ventspils Ganību iela
Installation : Avārijas apgaismojums
Project number : 1
Date : 06.02.2018

RELUX®

7 104

7.2 Summary, 104

7.2.1 Result overview, Evaluation area 1

Type No.\Make

3	1	AWEX	
		Order No.	: AXPU/1W - CB
		Luminaire name	: AXPU/1W - CB
		Equipment	: 1 x AXPU/1W - CB 1 W / 150 lm



Object : Ventspils Ganību iela
 Installation : Avārijas apgaismojums
 Project number : 1
 Date : 06.02.2018

RELUX®

8 101

8.1 Description, 101

8.1.1 Floor plan

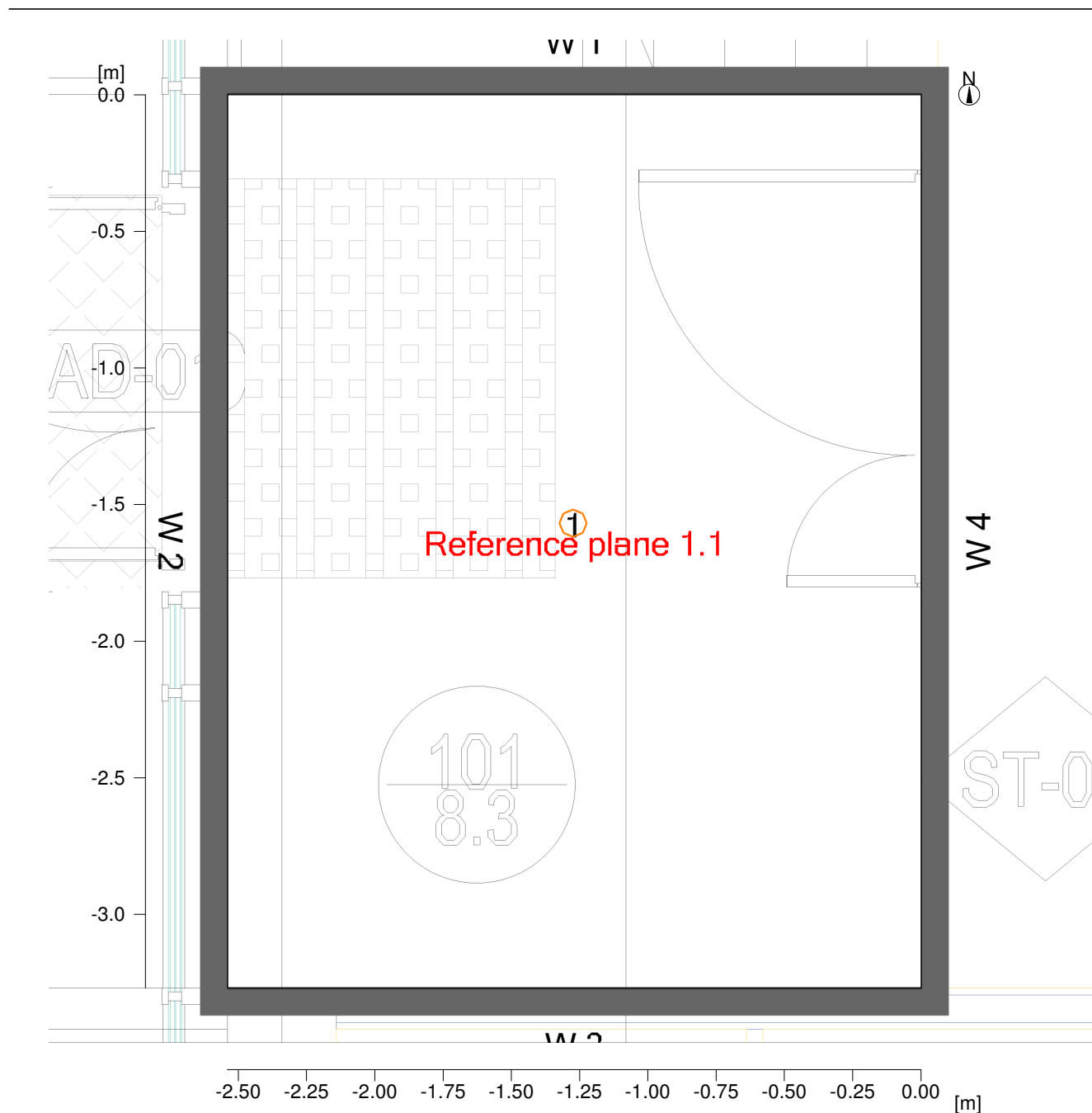

Wall	x	y	Length	Reflectance
1	67.90 m	221.30 m	2.54 m	50.0 %
2	67.90 m	218.03 m	3.27 m	50.0 %
3	70.44 m	218.03 m	2.54 m	50.0 %
4	70.44 m	221.30 m	3.27 m	50.0 %
Floor				20.0 %
Ceiling				70.0 %
Room height		3.00 m		
Height of reference plane		0.00 m		

Object : Ventspils Ganību iela
 Installation : Avārijas apgaismojums
 Project number : 1
 Date : 06.02.2018

RELUX®

8 101

8.2 Summary, 101

8.2.1 Result overview, Evaluation area 1

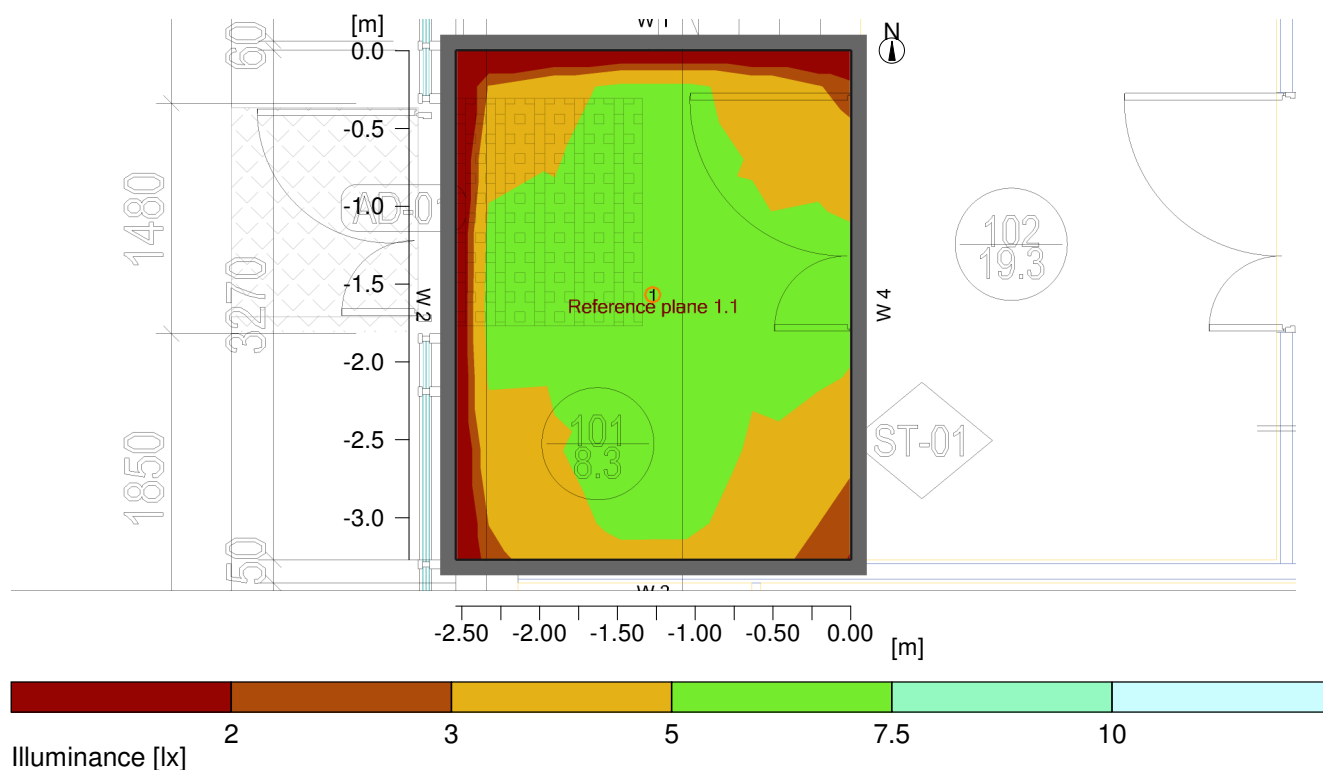

General

Calculation algorithm used
 Height of luminaire plane
 Maintenance factor

Average indirect fraction
 3.00 m
 0.80

Total luminous flux of all lamps
 Total power
 Total power per area (8.31 m²)

150.00 lm
 1.0 W
 0.12 W/m² (2.57 W/m²/100lx)

Evaluation area 1

Reference plane 1.1

Horizontal
 E_m 4.68 lx
 E_{min} 2.86 lx
 E_{min}/E_{av} (U_o) 0.61
 E_{min}/E_{max} (U_d) 0.52
 UGR (2.0H 2.0H) ≤31.8
 Position 0.00 m

Type No.\Make

3 1 **AWEX**
 Order No. : AXPU/1W - CB
 Luminaire name : AXPU/1W - CB
 Equipment : 1 x AXPU/1W - CB 1 W / 150 lm